

Township 23S Range 03W

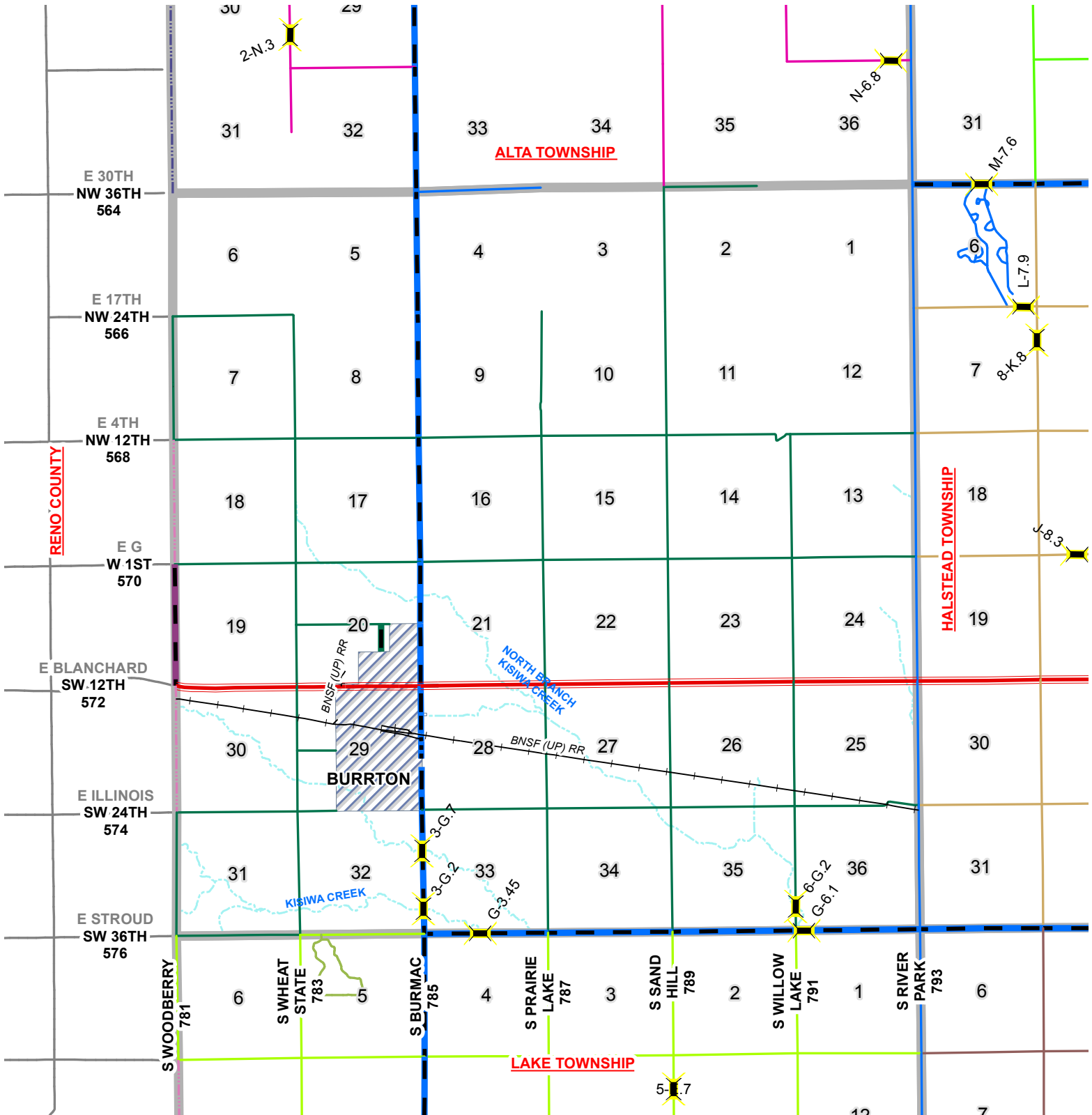

The information contained herein represents that information contained in official records. Any conclusions drawn from such information will be drawn at the sole risk of the user. The use of the data contained herein, and any products derived therefrom, for the purpose of solicitation to by or sell any product, property or service is strictly prohibited.



Legend

- Railroads
- Bridge # N-27.3
- KDOT
- Harvey County - Paved
- Harvey County - Unpaved
- Alta Township
- Burrton Township - Paved
- Burrton Township
- Lake Township
- Private
- Reno County - Paved
- Reno County - Unpaved
- RN-Little River Township
- RN-Valley Township
- Township Boundaries
- Corporate Limits
- Section Number
- Creeks/Rivers